

DO NOT SCALE

Millimetres

0 10

100

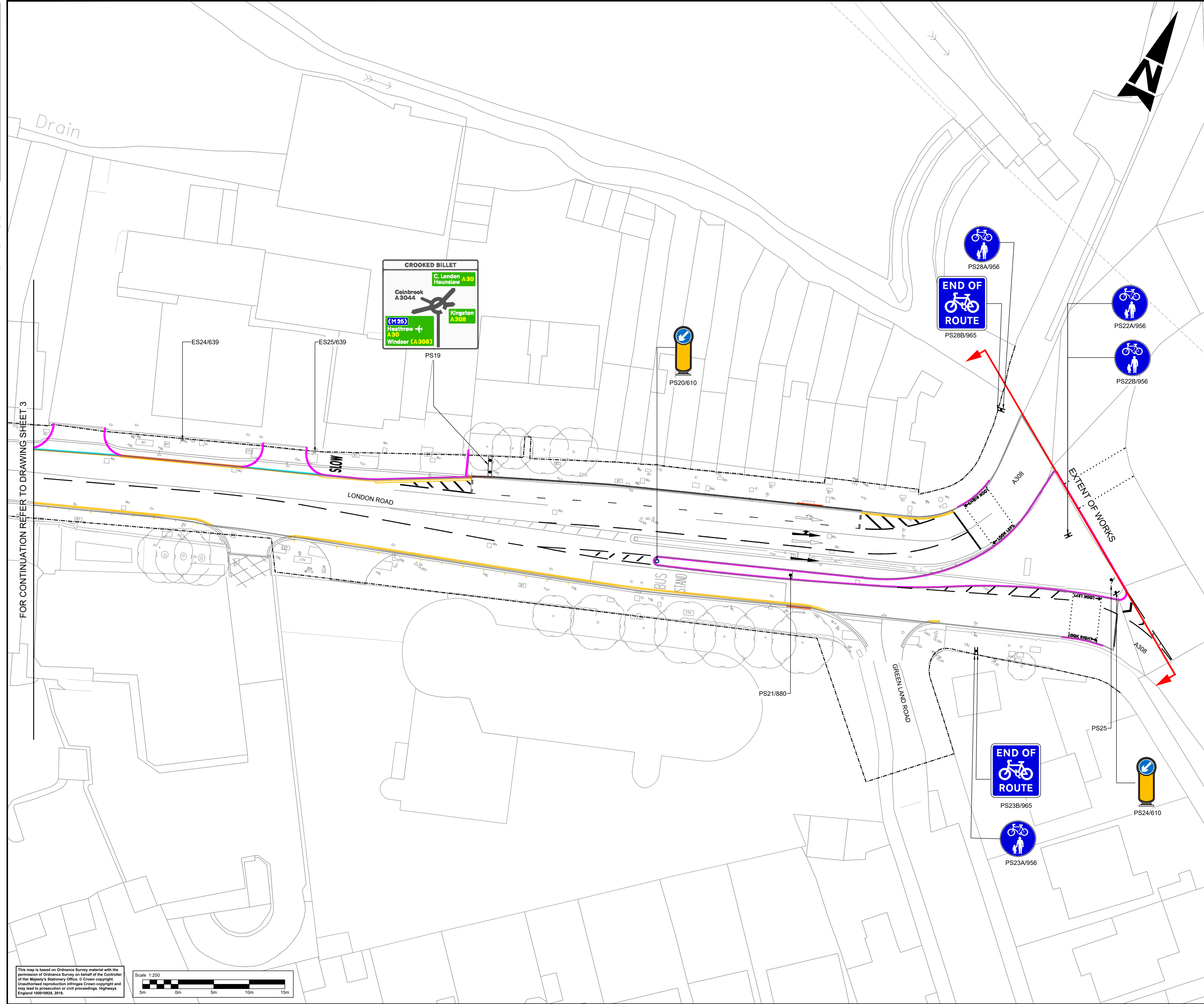

FOR CONTINUATION REFER TO DRAWING SHEET 3

NOTES

- DO NOT SCALE FROM THIS DRAWING.
- ALL DIMENSIONS ARE IN METRES UNLESS OTHERWISE STATED.
- FOR SPECIFICATION AND PROPOSED SIGN SCHEDULE REFER SCCLR308-ATK-HSN-XX-SH-000001
- ALL DIAGRAM NUMBERS ARE TO REFER TO THE TRAFFIC SIGNS REGULATIONS AND GENERAL DIRECTIONS 2016 AND ITS SUBSEQUENT AMENDMENTS.
- EXTENT OF WORKS AND LOCATION OF TRAFFIC SIGNS ARE APPROXIMATE AND ARE TO BE AGREED ON SITE.

KEY

- HIGHWAY BOUNDARY (AS PER CONCEPT PLAN)
- PROPOSED KERB
- EXTENT OF WORKS
- PROPOSED SIGN
- EXISTING SIGN AND POST TO BE RELOCATED
- EXISTING SIGN AND POST TO BE RETAINED

SAFETY, HEALTH AND ENVIRONMENTAL INFORMATION

In addition to the hazards/risks normally associated with the types of work detailed on this drawing, note the following significant residual risks (Reference shall also be made to the design hazard log).

Construction
(Enter "None" if applicable)

Maintenance / Cleaning
(Enter "None" if applicable)

Use
(Enter "None" if applicable)

Decommissioning / Demolition
(Enter "None" if applicable)

Description
ISSUE FOR CONSTRUCTION - PARKING RESTRICTION REMOVED

Status	Revision	Drawn	Checked	Reviewed	Authorised	Issue Date
A1	C02	MM	MF	MP	XW	27.07.20

Description
ISSUE FOR TENDER

Status	Revision	Drawn	Checked	Reviewed	Authorised	Issue Date
D2	P04	MM	MF	MP	XW	23.07.19

Description
ISSUED FOR ROAD SAFETY AUDIT

Status	Revision	Drawn	Checked	Reviewed	Authorised	Issue Date
S3	P03	MR	MF	MP	XW	20.05.19

Description
SECOND ISSUE

Status	Revision	Drawn	Checked	Reviewed	Authorised	Issue Date
S3	P02	MR	SG/UK	RM	XW	13.03.19

Description
FIRST ISSUE

Status	Revision	Drawn	Checked	Reviewed	Authorised	Issue Date
S3	P01	MR	SG/UK	RM	XW	18.02.19

Drawing Suitability: **FOR CONSTRUCTION** Status: **A1**

SNC-LAVALIN
ATKINS
Member of the SNC-Lavalin Group
Copyright © Atkins Limited (2019)

The Wells
3-13 Church Street
Epsom
Surrey
KT17 4PF
Tel: +44 (0)1372 726140
Fax: +44 (0)1372 740055
www.atkinsglobal.com

SURREY
COUNTY COUNCIL
Surrey Highways & Transport for Surrey

Project Title
**SURREY COUNTY COUNCIL IMPROVEMENT SCHEME
A308 LONDON ROAD / HIGH STREET**

Drawing Title
PROPOSED TRAFFIC SIGN LAYOUT

Drawing Number
Project: **SCCLR308 - ATK - HSN - XX - DR - CH - 000004**

Location
Original Size: **A1** Scale: 1:250 Project Ref. No: 5183206 Sheet: 4 of 4 Rev: **C02**

This map is based on Ordnance Survey material with the permission of Ordnance Survey on behalf of the Controller of Her Majesty's Stationery Office. © Crown copyright. Unauthorised reproduction infringes Crown copyright and may lead to prosecution or civil proceedings. Highways England 10001828, 2019.

