

Notes:

1. The contractor is responsible for verifying all site & setting out dimensions before commencing work.
2. This drawing is to be read in conjunction with all relevant Architectural and M & E drawings.
3. All dimensions in meters unless stated otherwise.
4. Traffic calming design based on LTN 1/07
5. To be read in conjunction with drawings: 4874-002-105, 4874-002-106 and 4874-002-107 for Standard Details.
6. To be read in conjunction with drawings: 4874-002-108, 4874-002-109, 4874-002-110 and 4874-002-111 for Utilities information
7. To be read in conjunction with drawings: 4874-002-201, 4874-002-202, 4874-002-203 and 4874-002-204 for Site clearance information
8. Utility information has been included where available. Contractor should allow for protection of further utilities following comprehensive survey.
9. Exact layby waiting restrictions to be determined by SCC

Key:

- Proposed Footway
 - Proposed Carriageway
 - Proposed Wooden Fence Gateway
 - Proposed high visibility pedestrian guard rail
 - Proposed Traffic Sign. See drg.4874-002-106 for Schedule
 - Proposed Tactile Paving
 - Proposed HB2 kerb
 - Proposed edging kerb
 - Proposed dropped kerb
 - Proposed transition kerb
 - Public Highway Boundary
 - Surface Water Drainage Channel
 - Double HB2 kerb retaining feature
- Proposed Road Markings. See drg.4874-002-106 for Road marking Schedule

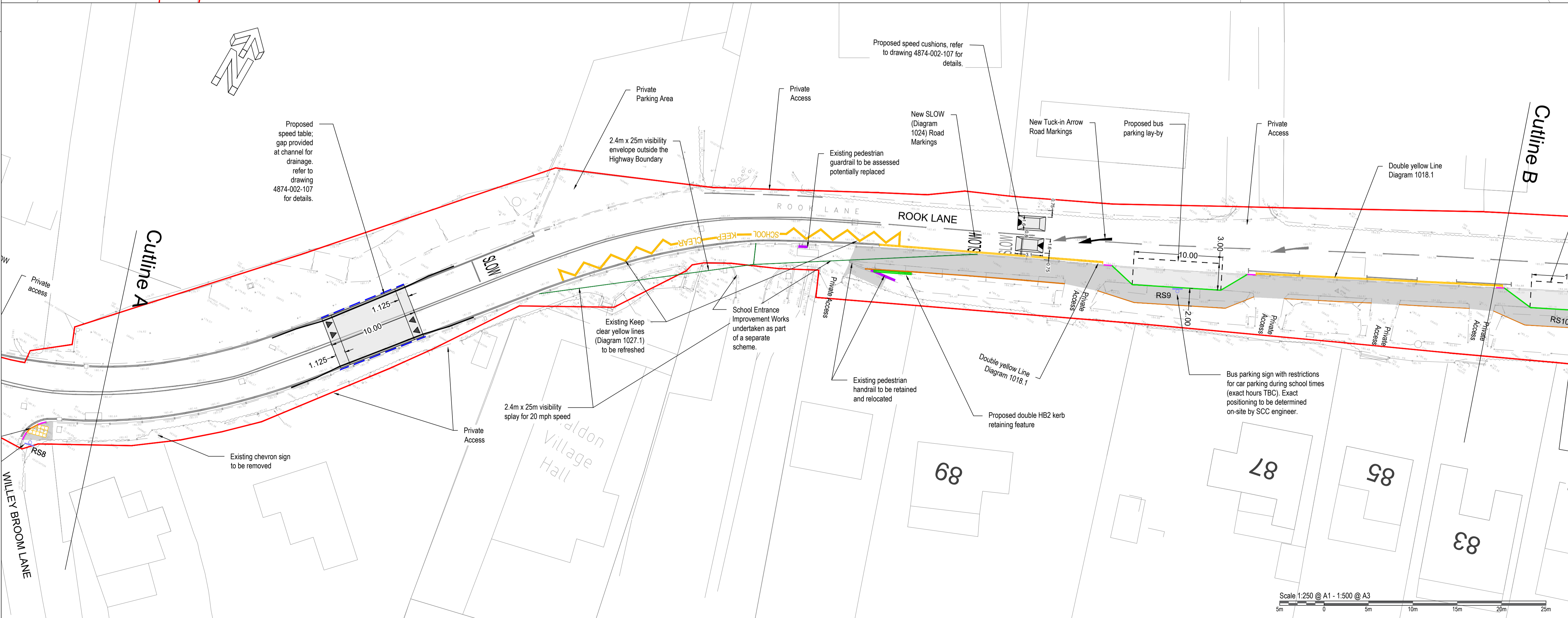
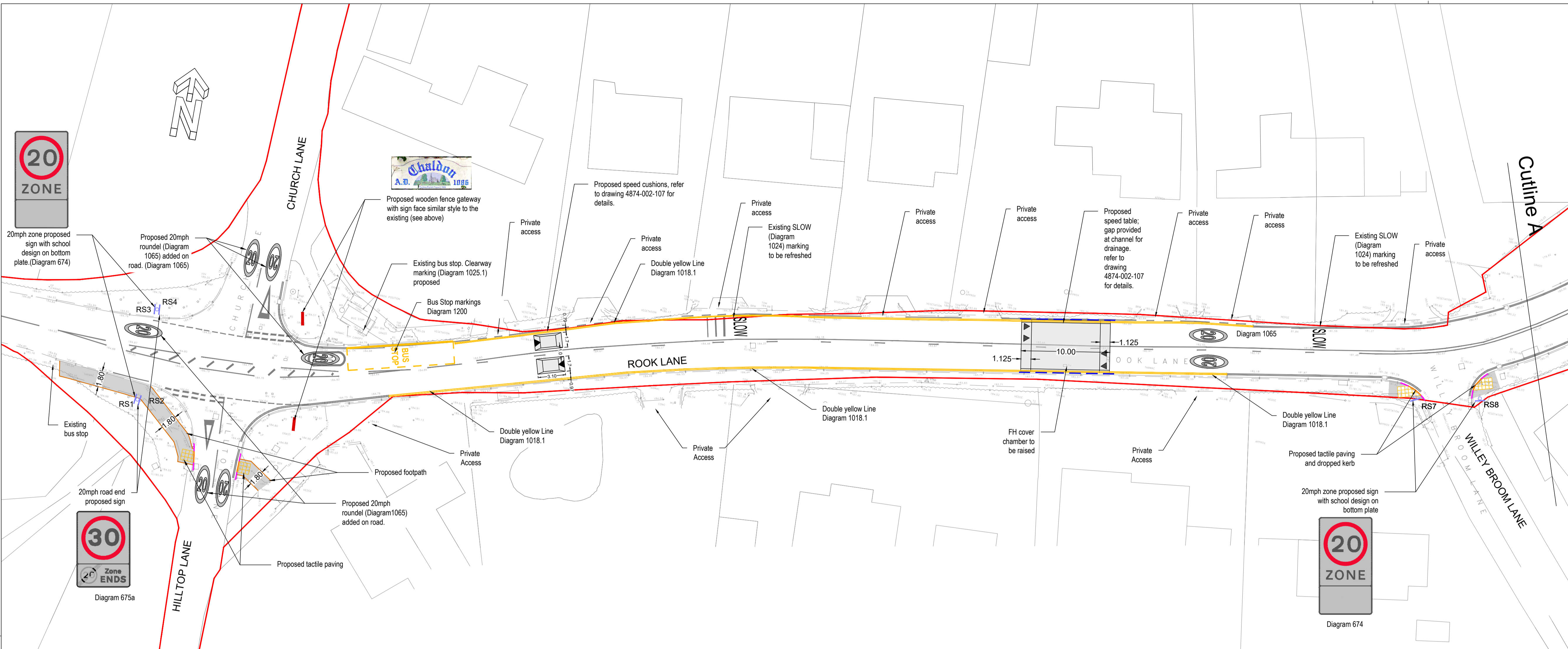

Revision History					
Rev	Comment	By	Chkd	Appr	Date
P04	Updated to additional SCC Comments	CR	CR	GK	08/01/2024
P03	Updated to RSA Comments	FR	CR	GK	15/12/2023
P02	Detail Design	CP	SB	AMI	07/06/2023
P01	For Tender	CP	SB	AMI	15/02/2023
Current Revision					
P05	Minibus sign updated	CR	CR	GK	12/01/2024

DETAIL DESIGN

PELLINGS



Project: ST. PETER AND ST. PAUL SCHOOL

Drawing Title: GENERAL ARRANGEMENT Sheet 01 of 04

RWCL Internal Register reference: 4874-002 Scales @ A1

