

CONSTRUCTION
ISSUE

| | | | | | |
|-----|--|-----|-----|-----|----------|
| C06 | TRAFFIC CALMING DETAILS ADDED. DIMENSIONS ADDED TO RAISED TABLES | LT | LT | GT | 13.06.23 |
| C05 | SEGMENTATION BETWEEN CST KERBS ALONG RAISED TABLE ADDED | MR | MC | SB | 31/10/18 |
| C04 | ENTRANCE TO CALA RADIUS KERBS INCREASED TO AVOID CLASH WITH VALVE | MR | MC | SB | 24/10/18 |
| C03 | UPDATED FOLLOWING SCC TECHNICAL APPROVAL | MR | MC | SB | 07/09/18 |
| C02 | UPDATED TO SCC COMMENTS | MR | MC | SB | 30/05/18 |
| Rev | Amendments | Dim | Chk | App | Date |

Odyssey
Markides

Elizabeth House
39 York Road
London
SE1 7NG

Telephone: 0207 420 3444
Fax: 0207 420 1168
E: enquiries@odysseymarkides.com
W: www.odysseymarkides.com

Job Title
MINDENHURST, CAMBERLEY,
SURREY

Drawing Title **SPINE ROAD PHASE 2 -
(BRUNSWICK ROAD)
PAVEMENT TYPES SHEET 1 OF 2**

Client **SKANSKA**

| | | |
|--------------------|--|-----------------|
| Scale 1:500 @A1 | Date AUG.17 | Designed CDU |
| Drawn CDU | Checked JM | Approved JM |
| Job No 14-199 | Drawing No DC1-ODM-CH-215-XX-DR-96-1101 | Rev C06 |

- CONSTRUCTION
ISSUE**

| | | | | | |
|-----|--|-----|-----|-----|----------|
| C05 | EF EDGING REMOVED FROM VEHICLE CROSS OVERS | MR | MC | SB | 02/11/11 |
| C04 | VEHICLE CROSSOVERS ADDED | MR | MC | SB | 31/10/11 |
| C03 | UPDATED FOLLOWING SCC TECHNICAL APPROVAL | MR | MC | SB | 07/09/11 |
| C02 | UPDATED TO SCC COMMENTS | MR | MC | SB | 30/05/11 |
| Rev | Amendments | Orn | Chk | App | Date |



Job Title
MINDENHURST, CAMBERLEY,
SURREY

Drawing Title SPINE ROAD PHASE 2 -
(BRUNSWICK RD)
PAVEMENT TYPES SHEET 2 OF 2

SKANSKA

| | | |
|--------------------|--|-----------------|
| Scale 1:500 @A1 | Date AUG.17 | Designed CDU |
| Drawn CDU | Checked JM | Approved JM |
| Job No 14-199 | Drawing No DC1-00M-CH-215-XX-DR-96-1102 | Rev CO |

P:\15-373 - Deepcut Section 38 Spine Road Design\Tech\Acad\Drawings\SHW (Skanska) Series\Phase 3-4 Construction\1100 Series\DC1-ODM-TA-102-XX-DR-03-1100 Footpaths And Paved Areas.dwg

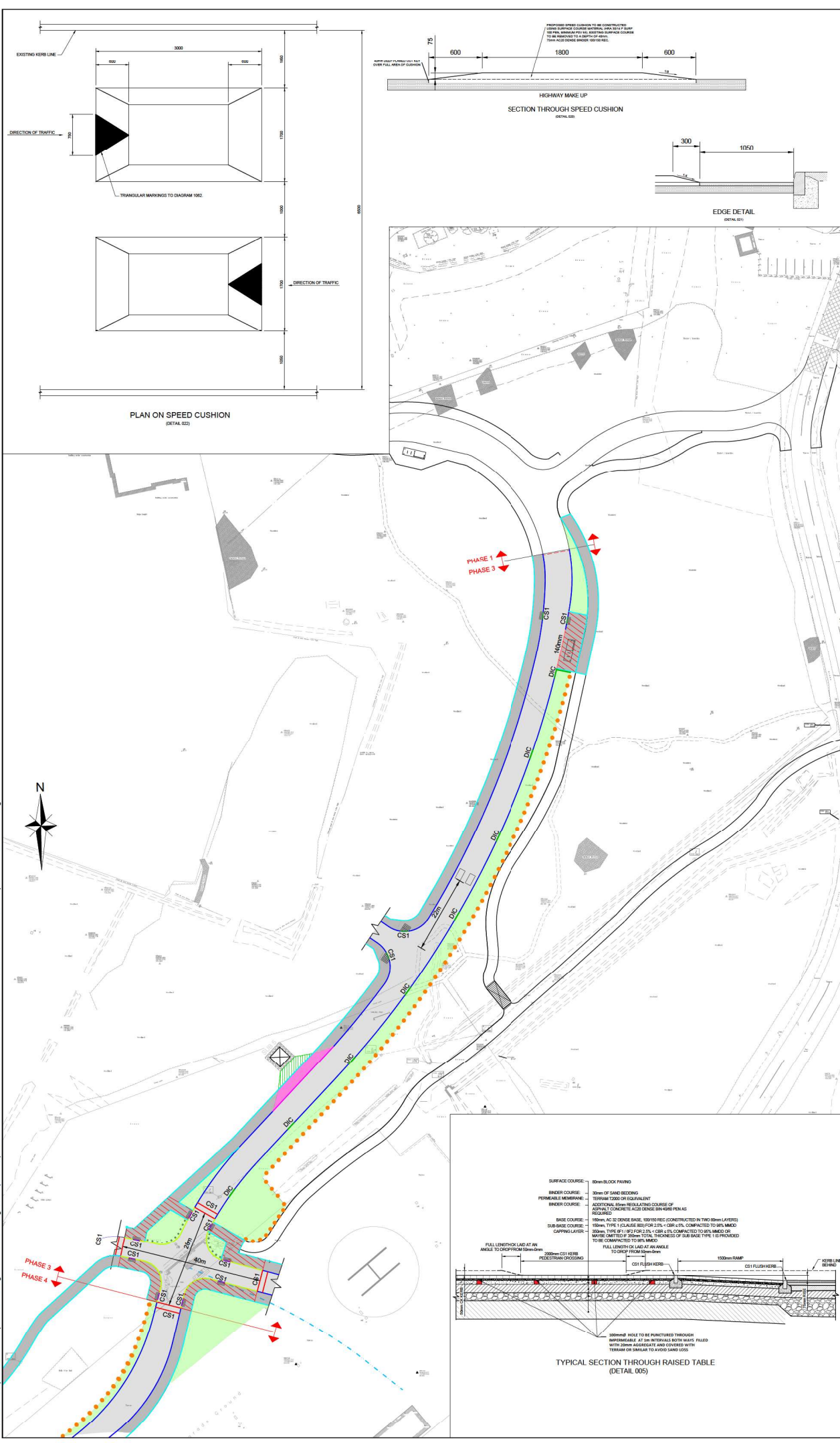

NOTES

- THIS DRAWING IS TO BE READ IN CONJUNCTION WITH ALL OTHER RELATED DRAWINGS ISSUED BY THE ARCHITECT AND ENGINEER. SEWERS FOR ADOPTION SIXTH/SEVENTH EDITION, SURREY COUNCIL STANDARDS.
- DO NOT SCALE FROM THIS DRAWING. WORK FROM FIGURED DIMENSIONS ONLY.
- ALL DIMENSIONS SHOWN IN METRES UNLESS NOTED OTHERWISE.
- NO DEVIATION FROM THE DETAILS SHOWN ON THIS DRAWING IS PERMITTED WITHOUT PERMISSION FROM THE ENGINEER.
- THE CONTRACTOR MUST REFER TO THE EXISTING SERVICES PLANS AND INFORMATION AND MUST LOCATE EXISTING SERVICES PRIOR TO ANY EXCAVATIONS. ALL EXCAVATION WORKS IN THE VICINITY OF EXISTING SERVICES SHOULD BE CARRIED OUT IN ACCORDANCE WITH HSG47.
- REFERENCE MUST BE MADE TO THE EXISTING SERVICES SURVEY AND INVESTIGATIONS.
- FINALISED PROPOSALS ARE SUBJECT TO CO-ORDINATION WITH THE COMBINED SERVICES PROPOSALS.
- CONTRACTOR TO CONFIRM POSITION OF STATUTORY UNDERTAKERS PLANT BEFORE COMMENCEMENT OF THE WORKS.
- THE TOPOGRAPHICAL SURVEY INFORMATION IS BASED ON DANDO SURVEYING LIMITED SHEET ID SHDEEPCUT3D, DATED 14TH MAY 2015.
- CONSERVATION KERBS ARE TO BE 145mm x 255mm SILVER GREY AND TO BE USED ADJACENT TO RAISED TABLES.
- REFER TO DRAWINGS DC1-ODM-TA-102-XX-DR-03-0706 AND 0707 FOR HIGHWAY CONSTRUCTION DETAILS.
- BLOCK PAVING TO BE 90 DEGREE HERRINGBONE PATTERN ON FOOTWAYS AND BUS STOPS AND 45 DEGREE HERRINGBONE PATTERN ON RAISED TABLES.

SECTION 38:

- PROPOSED ADOPTED HIGHWAY
- PROPOSED BLOCK PAVING CHARCOAL COLOUR HERRINGBONE PATTERN 200 x 100 x 50mm THICK MARSHALL KEYBLOK STANDARD FINISH
- VEHICULAR CROSSOVER SEE DETAIL 021 DC1-ODM-TA-102-XX-DR-03-0706
- 125mm HB KERB
- EF EDGING
- 140mm 140mm UPSTAND KERB
- CS1 0mm UPSTAND CS1 CONSERVATION KERBS (WITH TRANSITION KERB EITHER SIDE)
- CS1 0mm UPSTAND CS1 KERB (WITH TRANSITION KERB EITHER SIDE)
- CS1 0mm UPSTAND CS1 KERB (ALONG RAISED TABLES)
- DIC DROPPED KERB FOR DRAINAGE INLET TO HIGHWAY SWALE
- CONSERVATION KERB (ALONG RAISED TABLES) 50mm LUNI FSS NOTED OTHERWISE
- 45° SPLAYED KERB
- TIMBER CHESNUT POSTS (AT 2.5m CENTRES). SEE POST DETAIL 2 AT DWG DC1-ODM-CH-102-XX-DR-03-0707
- TIMBER EDGING
- PROPOSED ADOPTED FOOTPATHS / CYCLEWAYS
- GRASSCRETE (TYPE GC1 WITH A193 MESH)
- SUBSTATION
- SWALE BRIDGE (REFER TO NEIL TULLEY DRAWING DC1-NTA-102-00-DR-04-0005-R05)

FOR CONSTRUCTION

KEY PLAN

| Rev | Amendment | On | Chg | App | Date |
|-----|--|-----|-----|-----|----------|
| C02 | TRAFFIC CALMING DETAILS ADDED. DIMENSIONS ADDED TO RAISED TABLES | LT | LT | TD | 13.06.23 |
| C01 | ISSUED FOR CONSTRUCTION | CB | PW | PD | 06/02/20 |
| T13 | RAISED TABLE LOCATION REVERTED | JEM | PW | PD | 25/04/19 |
| T12 | BOLLARDS PHASE 1 UPDATE | JEM | MC | SB | 11/04/19 |
| T11 | BOLLARDS ADDED | JEM | MC | SB | 10/01/19 |
| T10 | SUBSTATION 5 UPDATED | JEM | MC | SB | 29/11/18 |

Odyssey Markides

London Road, 28 West End, London, W12 7TG

Telephone: 0203 486 4844 Fax: 0203 486 1888 Email: enquiries@odyssey-markides.com Website: www.odyssey-markides.com

Job Title: MINDENHURST CAMBERLEY, SURREY

Drawing Title: SPINE ROAD - PHASE 3 FOOTPATHS AND PAVED AREAS SHEET 1 OF 2

Client: SKANSKA

| Scale: | Date: | Designed: |
|-----------|--------|-----------|
| 1:500@ A1 | JAN'16 | MM |

| Drawn: | Checked: | Approved: |
|--------|----------|-----------|
| MM | JM | SRB |

Job no: 15-373 Drawing no: DC1-ODM-TA-102-XX-DR-03-1100 Rev: C02

