

- KEY**
- Existing road markings to be refreshed
  - Existing road markings to remain
  - Proposed 'Red' coloured tactile.
  - Proposed 'Buff' coloured tactile.
  - Proposed footway re-surfacing
  - Proposed full depth footway construction
  - Zebrite Post Top Belisha Beacon and Halo unit
  - Existing gully to remain
  - Proposed gully (2 No.) to be installed
  - Proposed gully connection into existing drainage system.
  - Existing guardrailling to be removed
  - Install new 'Charcoal' coloured high friction surfacing

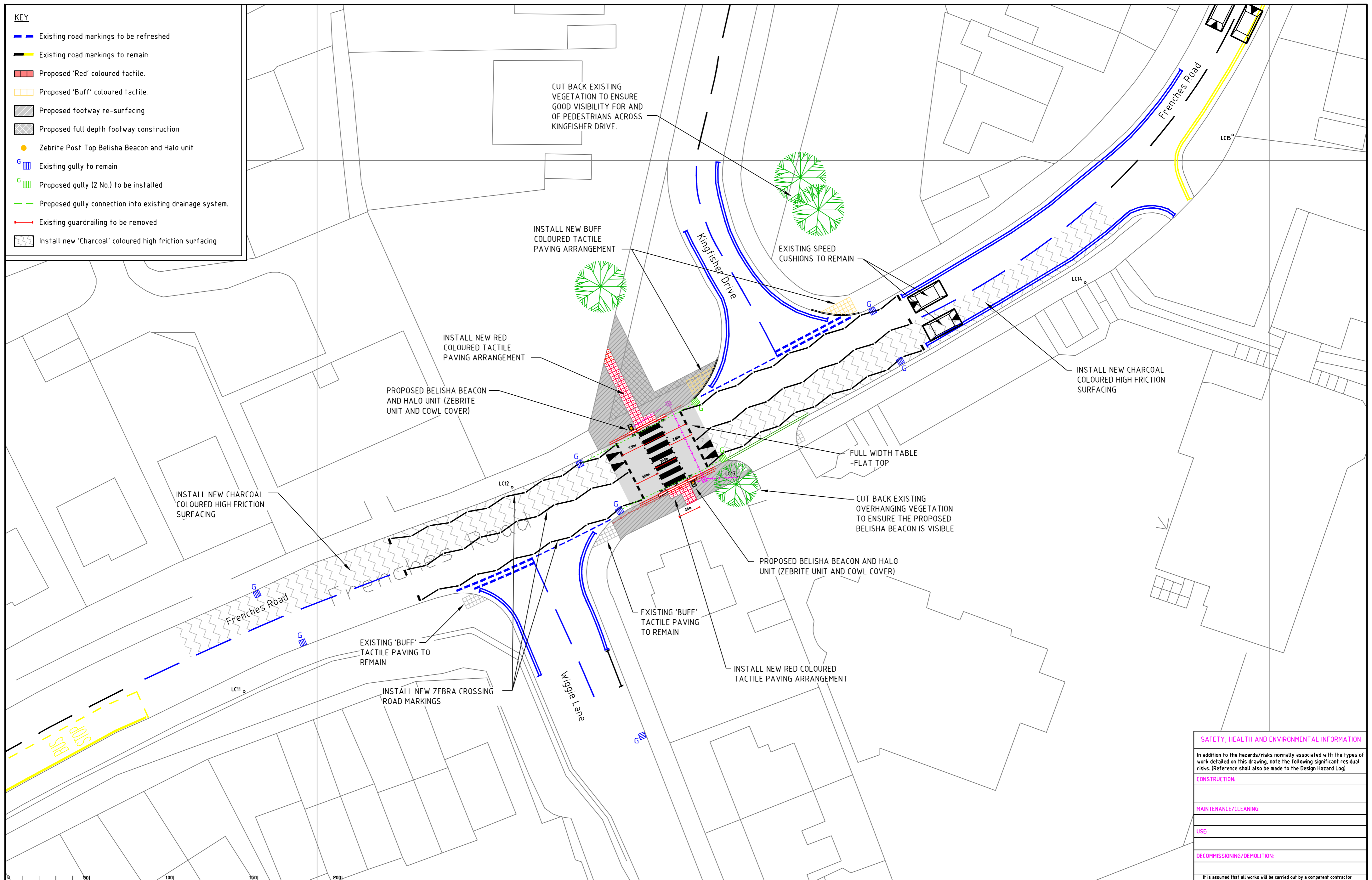

**SAFETY, HEALTH AND ENVIRONMENTAL INFORMATION**

In addition to the hazards/risks normally associated with the types of work detailed on this drawing, note the following significant residual risks. (Reference shall also be made to the Design Hazard Log)

|                             |
|-----------------------------|
| CONSTRUCTION:               |
|                             |
| MAINTENANCE/CLEANING:       |
|                             |
| USE:                        |
|                             |
| DECOMMISSIONING/DEMOLITION: |
|                             |

If it is assumed that all works will be carried out by a competent contractor working, where appropriate, to an approved method statement.

Notes

| Rev. | Description | Drwn | Sig. | Date | Chkd | Sig. | Date | Appr | Sig. | Date |
|------|-------------|------|------|------|------|------|------|------|------|------|
|      |             |      |      |      |      |      |      |      |      |      |
|      |             |      |      |      |      |      |      |      |      |      |
|      |             |      |      |      |      |      |      |      |      |      |
|      |             |      |      |      |      |      |      |      |      |      |
|      |             |      |      |      |      |      |      |      |      |      |
|      |             |      |      |      |      |      |      |      |      |      |
|      |             |      |      |      |      |      |      |      |      |      |

| Drwn | Sig. | Date | Chkd | Sig. | Date | Appr | Sig. | Date |
|------|------|------|------|------|------|------|------|------|
|      |      |      |      |      |      |      |      |      |
|      |      |      |      |      |      |      |      |      |
|      |      |      |      |      |      |      |      |      |
|      |      |      |      |      |      |      |      |      |
|      |      |      |      |      |      |      |      |      |
|      |      |      |      |      |      |      |      |      |
|      |      |      |      |      |      |      |      |      |
|      |      |      |      |      |      |      |      |      |

North Point

Based upon the Drainage Survey mapping with permission of the Controller of Her Majesty's Stationery Office © Crown copyright. Unauthorised reproduction infringes Crown copyright and may lead to prosecution or civil proceedings. Surrey County Council LA 076872 2005.

|             |    |      |    |      |          |
|-------------|----|------|----|------|----------|
| Drawn by    | DM | Sig. | DM | Date | 16.07.21 |
| Checked by  | JD | Sig. |    | Date |          |
| Approved by | JD | Sig. |    | Date |          |

Project: Frenches Road nr. Wiggle Lane, Redhill Proposed Pedestrian Crossing Facility

Scale: 1:250 @ A2

Frenches Road nr. Wiggle Lane, Redhill  
Proposed Pedestrian Crossing Facility

Consultation Drawing  
General Arrangement

SHEET 1 OF 1

Project No. PC1158

Contract Sheet No. CON01

Rev. -

Classification CONSULTATION

SURREY COUNTY COUNCIL  
Surrey's Partner  
Council for Surrey