

- Drawing Notes PC1312/General Arrangement**
- All dimensions are given in metres and levels in metres Above Ordnance Datum (mAOD).
 - This drawing is for general arrangement purposes only and is not to be used for the execution of any activity.
 - This drawing is to be read in conjunction with all other drawings, the Contract Specification, Specification for Highways Works and documentation supplied by the Engineer. This shall include Surrey County Council Standard Details and Pre-Construction Information (PCI).
 - The Contractor shall retain one copy of all documents and drawings permanently in the site office/welfare unit.
 - The Contractor shall ensure that the standard detail drawings are kept on site and are accessible to all personnel on site.
 - This drawing details non-invasive works only. The Contractor shall not use this drawing as a basis to carry out activities where excavation is required.
 - The Manual of Contract Documents for Highways Works (MCHW) shall be applicable for tasks not expressly covered with items published in the Contractors Schedule of Rates.
 - The Contractor's working hours shall be considered to be those on the relevant streetworks permits.
- Site Constraints**
- Apart from activities required to be carried out at night, working hours are 07:30 – 17:30, Monday to Friday unless stated otherwise in the traffic permits or otherwise accepted by the Engineer.
 - All traffic management to be compliant with Chapter 8, Traffic Signs Manual.
 - The Contractor shall keep stockpiles/material storage strictly confined to areas accepted by the Engineer in advance.
 - A number of commercial premises exist at the site and the Contractor is expected to endeavor not to disrupt the day-to-day operation of businesses so far as is practicable.
 - The Contractor shall keep width free of obstruction and for access by emergency vehicles.
- Health & Safety**
- No construction shall take place until an acceptable Construction Phase Plan (CPP) has been prepared.
 - The Contractor shall provide adequate welfare facilities which are to be located only in areas agreed with the Client.
 - No excavation shall be carried out until the locations of buried services have been marked out, including private supply and building drainage where identified. This shall consist of the very least use of rod/detection equipment, such as 'Cat & Genny'.
 - The Contractor shall prepare task-specific method statements and risk assessments for any residual site-specific hazards identified in the Pre-Construction Information, or annotated on scheme drawings.
- Client-appointed Third Parties**
- The Contractor shall allow for the accommodation of Client-appointed third parties and statutory undertakers within their programme, sequence of construction and prices.
 - The Contractor shall recognise that certain activities cannot take place without prior work being undertaken by third parties, e.g. electrical disconnections and programme the works and adjust the construction sequence accordingly.
 - Third parties required for the works are:
 - Skanska – Highway electrical works, e.g. street lighting and illuminated traffic signs/beacons.
 - Thames Water – Relocation of Fire Hydrants.
 - UKPN – Diversion of mains electricity.
 - Svetofar/Siemens – Traffic Signal Installation.
- KEY (GENERAL ARRANGEMENT – 100)**
- FOOTWAY INLAY – 70mm THICK COMPRISING 20mm THICK SURFACE COURSE AC6 DENSE SURF 100/150 AND 50mm THICK BINDER COURSE REGULATING COURSE AC20 DENSE BN 100/150 – REFER TO SCC SD 1000/09J – TOTAL AREA 48.10m²
 - PROPOSED CARRIAGEWAY SURFACE COURSE RE-SURFACING – SURFACE COURSE AND BINDER COURSE – 100mm DEPTH TOTAL BOND COAT (AS PER REQUIREMENTS SET OUT IN BS 594987 TABLE 2) IS TO BE INSTALLED ATOP PLANNED CARRIAGEWAYS EXTENTS; 60mm DEPTH BINDER COURSE – AC20 HIGH CLAUSE 923 WIR2 (OR SIMILAR TO BE APPROVED BY SCC ENGINEER); BOND COAT (AS PER REQUIREMENTS SET OUT IN BS 594987 TABLE 2); 40mm DEPTH SURFACE COURSE – SMA 10 FMB (AGGREGATE INDUSTRIES S.M.A. Tex 942) SURF TO CLAUSE 942 (BSA HAPAS APPROVED) 60+ (OR SIMILAR TO BE APPROVED BY SCC ENGINEER) – TOTAL AREA 320.10m²
 - FULL FOOTWAY CONSTRUCTION – COMPRISING TYPE 1 SUBBASE 100mm THICK AC20 DENSE 100/150 BINDER COURSE 50mm THICK AND AC6 DENSE 100/150 TO BS EN13106.1 SURFACE COURSE 20mm THICK
 - CARRIAGEWAY TO BUILDOUT – 125mm THICK COMPRISING 20mm THICK SURFACE COURSE AC6 DENSE SURF 100/150 AND 105mm THICK BINDER COURSE REGULATING COURSE AC20 DENSE BN 100/150 – REFER TO SCC SC 1000/15F
 - EXISTING GRASSED VERGE TO REMAIN
 - EXISTING KERBS TO BE REMOVED
 - NEW KERBS TO HAVE A 125mm UPSTAND
 - INDIVIDUAL KERB – TYPE DEFINED – REFER TO SCC SD 1000/03F & 1000/07F
 - LENGTH OF KERB – TYPE DEFINED
 - PROPOSED 'RED' TACTILE PAVING
 - EXISTING 'BUFF' TACTILE PAVING TO REMAIN
 - PROPOSED ROAD MARKINGS TO BE LAID IN ACCORDANCE WITH TSRGD
 - EXISTING ROAD MARKINGS TO BE REMOVED
 - EXISTING ROAD MARKINGS TO REMAIN
 - DOUBLE YELLOW LINING TO BE LAID/REFRESHED IN ACCORDANCE WITH TSRGD
 - TSRGD ROAD MARKING DIAG. NUMBERS
 - TRAFFIC SIGNAL RETENTION SOCKET (NAL RS115) OR SIMILAR TO BE INSTALLED AS PER THE MANUFACTURERS INSTRUCTIONS – SOCKETS TO BE 600mm UNLESS OTHERWISE SPECIFIED – REFER TO SCC SD 1000/403B
 - PROPOSED TRAFFIC SIGNAL DUCTING TO BE INSTALLED. HPDE/MPDE/UPVC 100mm 'ORANGE' DUCTING – REFER TO SCC SD 1000/404B (1-WAY, 2-WAY & 4-WAY DUCT AS SPECIFIED)
 - PROPOSED TRAFFIC SIGNAL DRAWPIST TO BE INSTALLED. NAL 'STARKKABOX' (OR SIMILAR TO BE USED), 450mm x 450mm IN SIZE – REFER TO SCC SD 1000/402B
 - PROPOSED TRAFFIC SIGNAL DRAWPIST TO BE INSTALLED. NAL 'STARKKABOX' (OR SIMILAR TO BE USED), 600mm x 450mm IN SIZE – REFER TO SCC SD 1000/402B

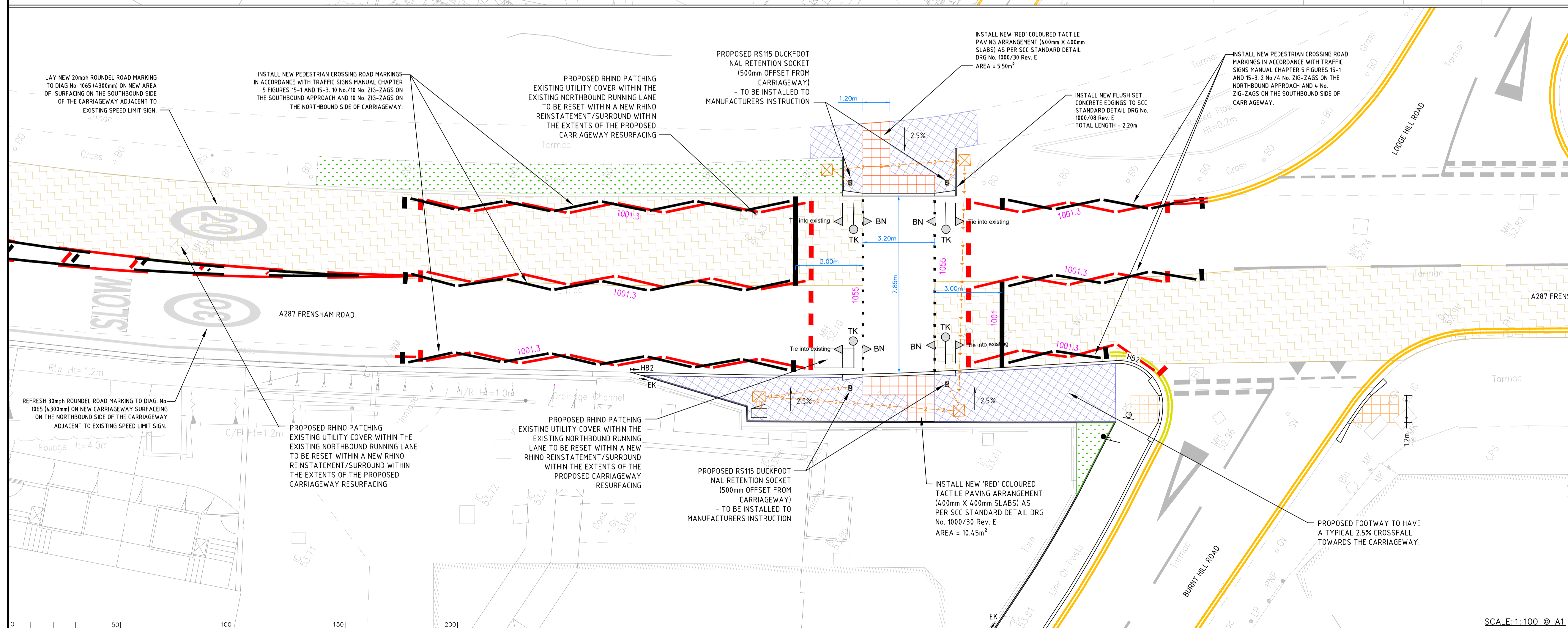

Notes

Rev.	Description	Drwn	Sig.	Date	Chkd	Sig.	Date	Appr	Sig.	Date

North Point	Based upon the Ordnance Survey mapping with the permission of the Controller of Her Majesty's Stationery Office © Crown copyright. Unauthorised reproduction infringes Crown copyright and may lead to prosecution or civil proceedings. Surrey County Council LA 076872 2002.
Drawn by	DM
Checked by	DM
Approved by	DM
Date	01.07.2023

Project: A287 Frensham Road j/w Burnt Hill Road and Lodge Hill Road, Lower Bourne, Farnham

Drawing: Proposed Signalised Pedestrian Crossing General Arrangement

Project No. PC1312

Contract Sheet No. PC1312-001

Rev. -

Classification: DRAFT

SHEET 1 OF 1

Scale: 1:100 @ A1