

CONTINUATION - SCALE 1:200m AT A1

OVERVIEW OF PROPOSED TROs
SCALE 1:200m AT A1

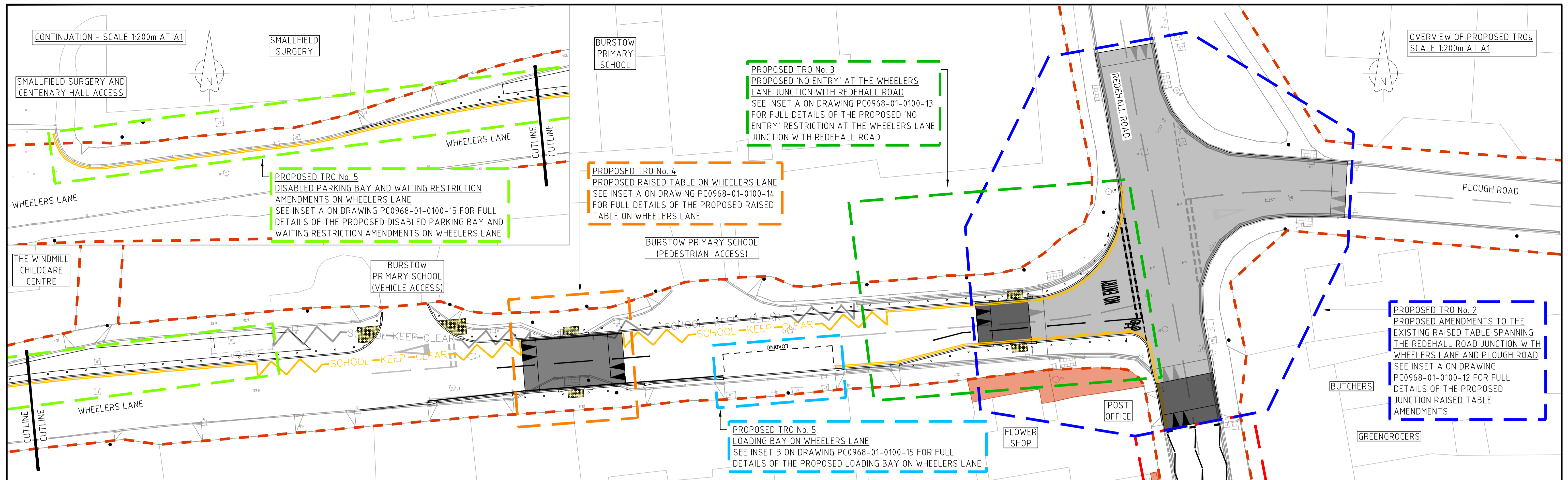

INSET A - TRO No. 3
SCALE 1:100m AT A1



PROPOSED TRO No. 3
PROPOSED 'NO ENTRY' AT THE WHEELERS LANE JUNCTION WITH REDEHALL ROAD
 A 'NO ENTRY' T.R.O IS REQUIRED TO ENABLE 'NO ENTRY' SIGNS TO BE PLACED EITHER SIDE OF THE REVISED LAYOUT ON WHEELERS LANE AT THE JUNCTION WITH REDEHALL ROAD, TO PREVENT VEHICLES FROM TURNING INTO WHEELERS LANE FROM ANY DIRECTION (INCLUDING FROM REDEHALL ROAD (FROM EITHER DIRECTION) OR ACROSS FROM PLOUGH ROAD) VEHICULAR ACCESS TO RESIDENTIAL PROPERTIES, LOCAL SERVICES AND BURSTOW PRIMARY SCHOOL ON WHEELERS LANE WILL BE VIA REDEHALL ROAD, WEATHERHILL ROAD AND BROADBRIDGE LANE. AN EXEMPTION TO THE 'NO ENTRY' RESTRICTION IS PROPOSED FOR CYCLISTS AND EQUESTRIAN USERS

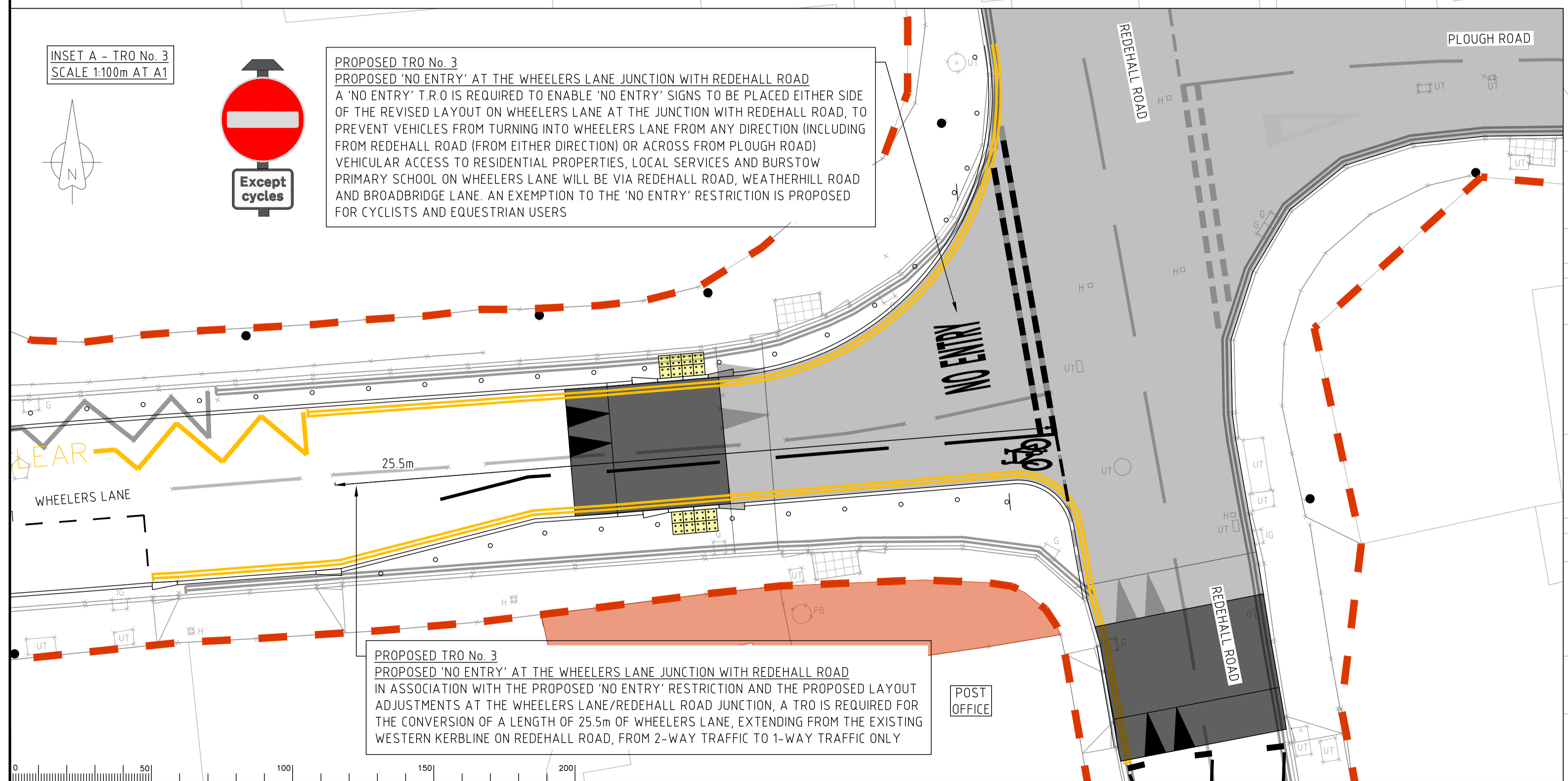

PROPOSED TRO No. 3
PROPOSED 'NO ENTRY' AT THE WHEELERS LANE JUNCTION WITH REDEHALL ROAD
 IN ASSOCIATION WITH THE PROPOSED 'NO ENTRY' RESTRICTION AND THE PROPOSED LAYOUT ADJUSTMENTS AT THE WHEELERS LANE/REDEHALL ROAD JUNCTION, A TRO IS REQUIRED FOR THE CONVERSION OF A LENGTH OF 25.5m OF WHEELERS LANE, EXTENDING FROM THE EXISTING WESTERN KERBLINE ON REDEHALL ROAD, FROM 2-WAY TRAFFIC TO 1-WAY TRAFFIC ONLY

PROPOSED TRO No. 1
PROPOSED ZEBRA CROSSING ON REDEHALL ROAD
 SEE INSET A ON DRAWING PC0968-01-0100-11 FOR FULL DETAILS OF THE PROPOSED ZEBRA CROSSING

PROPOSED TRO No. 5
PARKING BAY AND WAITING RESTRICTION AMENDMENTS ON REDEHALL ROAD
 SEE INSET C ON DRAWING PC0968-01-0100-15 FOR FULL DETAILS OF THE PROPOSED PARKING BAY AND WAITING RESTRICTION AMENDMENTS ON REDEHALL ROAD

SAFETY, HEALTH AND ENVIRONMENTAL INFORMATION

In addition to the hazards/risks normally associated with the types of work detailed on this drawing, note the following significant residual risks. (Reference shall also be made to the Design Hazard Log)

CONSTRUCTION:
MAINTENANCE/CLEANING:
USE:
DECOMMISSIONING/DEMOLITION:

It is assumed that all works will be carried out by a competent contractor working, where appropriate, to an approved method statement.

Notes

Rev.	Description	Drwn	Sig.	Date	Chkd	Sig.	Date	Appr	Sig.	Date

Drwn	Sig.	Date	Chkd	Sig.	Date	Appr	Sig.	Date

North Point

VARIES AS SHOWN

Scale VARIES - AS SHOWN

*Based upon the Ordnance Survey mapping with the permission of the Controller of Her Majesty's Stationery Office © Crown copyright. Unauthorised reproduction infringes Crown copyright and may lead to prosecution or civil proceedings. Surrey County Council LA 076872 2002.

Drawn by	SP	Sig.	SP	Date	AUG 23
Checked by	SP	Sig.	SP	Date	AUG 23
Approved by		Sig.		Date	

Project
**PEDESTRIAN ACCESSIBILITY AND SAFETY IMPROVEMENTS
 WHEELERS LANE AND REDEHALL ROAD, SMALLFIELD**

Drawing
**PROPOSED WHEELERS LANE/REDEHALL ROAD 'NO ENTRY'
 TRO DRAWING**

SHEET 1 OF 1

Project No.
PC0968

Contract Sheet No.
01-0100-13

Rev.
-

Classification
DRAFT

SURREY COUNTY COUNCIL
 Safer, Smoother, Stronger
 Improving the way we live