

**Illuminated Sign Specification**  
(Ref: Sign 8)

Sign 8 (1/3 sign only, Dia: 606)  
LANTERN DETAILS  
Lantern Manufacturer: Simonsgin  
Lantern Type: LIA LED integrated unit  
Lantern Colour: Acrylic Grey  
Mounting Requirement: Post Top  
LED Colour Temperature: Neutral White (4000K)  
LED Version: 3 x 1 watt  
LED Quantity: 3  
Photo Cell: All night electronic one-part miniature photo-cell.  
Switch regime 806, Dusk to dawn (35 lux switch on/18 lux switch off).  
SIGN POST DETAILS  
Straight Sign Post Manufacturer: NAL Ltd  
Type: NAL Ductbot 38mm retention socket with SIS Sole underground disconnection system with impact sensor. To be located in 450 mm x 600mm Sika Box System with composite cover and deep frame to Surrey PFI specifications.  
Post Type: 88mm steel galvanneal straight post less than 3.2mm wall thickness  
Height: Dia 606 Sign plate to be installed 100mm above the Dia 515 chevron plate  
Finish: Hot dipped galvanneal and coated with a manufacturer applied system which provides additional protection against corrosion but without the requirement for routine maintenance or re-application.  
Finish Colour: BS4800: Grey: 10 A 07

Sign No.	Diag. No.	Description	Illuminated
①	512	Warning of a Harsh Turning	No
②	610	Non-Illuminated Reflective Bollard	No
③	-	Temporary 'New Road Layout'	No
④	7014	Temporary 'New Road Layout'	No
⑤	Raise	Street Name Plate - SQUIRES BRIDGE ROAD	No - reused
⑥	Raise	Street Name Plate - STUDIOS ROAD	No
⑦	Raise	Street Name Plate - STUDIOS ROAD leading to HITCHCOCK CLOSE WILKIN GARDENS LION CLOSE KORDA CLOSE ASTLEHAM ROAD OBERTON WAY	No
⑧	515 & 606	Sharp Deviation of Route & Direction Sign	Yes
⑨	545 & 546	Warning Children Crossing Road & 'School' supplementary plate	As per plan

\* Sign 4 to be removed 3 months after completion of works

**For Technical Approval**  
This drawing is produced for the purposes of obtaining the approval of an adopting or maintaining authority, and reliance on this drawing, for whatever purpose, is at the developer/contractor's risk until formal technical approval has been received.

**GENERAL KEY**

- Site Boundary
- - - Existing Highway Boundary
- - - Proposed Chamber & Duct to supply illuminated signs

**GENERAL NOTES**

1. This drawing is based on the Topographical Survey undertaken by Warner Surveys, dated November 2020. Ref: 17/202/0529/P/0006 & 17/202/0529/P/0006\_LIG
2. Roundabout layout based upon approved planning drawing ref: ILL14055-GA-021 Rev C dated December 2018.
3. All adoptable highway works to be constructed in accordance with the current version of the Specification for Highway Works (SHW).
4. The Contractor shall seek clarification from the Engineer regarding any construction issue arising from this drawing, or any discrepancy between this drawing and any issued drawing or the Specification, prior to construction.
5. The works shown on this drawing could affect Statutory Undertaker's apparatus and the Contractor is required to verify the location and depth of all such apparatus prior to commencement of the works and to take any precautions necessary when working in the vicinity of any such apparatus.
6. All works within the limits of the highway shall be signed in accordance with the Traffic Signs Manual Chapter 9 Traffic Safety Measures and Signing for Road Works and Temporary Situations, 2016, as amended.
7. All dimensions shown in metres (m) unless otherwise stated, and all levels relate to Ordnance Datum.
8. The contractor shall confirm the CBR of the subgrade and shore results with the Highway Authority in order to determine the required subgrade thickness. Any revisions to the pavement design and specification to be agreed prior to construction. The Highway Inspector is to be present during inspections/CBR testing.
9. Prior to laying any material the subgrade must be proof rolled and inspected and any soft spots removed and filled with Type 2 material to SHW Clause 804. The sub-formation and formation shall be prepared in accordance with SHW clause 616.
10. Where fill is required beneath sub-formation or formation, this shall be carried out in accordance with SHW clause 608.
11. All materials within 450mm of finished levels should be non-roots susceptible.
12. All gully tops and manhole covers shall comply with BS EN124-2. Class D400 covers shall be used in carriageways.
13. Permanent road markings shall be white. Methyl Methacrylate road marking material complying with SHW Clause 1212.
14. All tactile paving surfaces shall be laid out in accordance with DETR's 'Guidance on the use of Tactile Paving Surfaces'.
15. All existing vegetation that overhangs the footway and extended highway shall be cut back. Notices shall be given by the Developer / Contractor to the owner of the vegetation, or occupier of the land on which it is situated, to require its removal within 14 days of the date of service of the notice.
16. All road markings and traffic signs shall comply with The Traffic Signs Regulations and General Directions 2016, as amended.
17. The position of all street furniture, including traffic signs, signs and lighting columns, shall be agreed with the Engineer and Highway Authority on site prior to installation and final surfacing works.

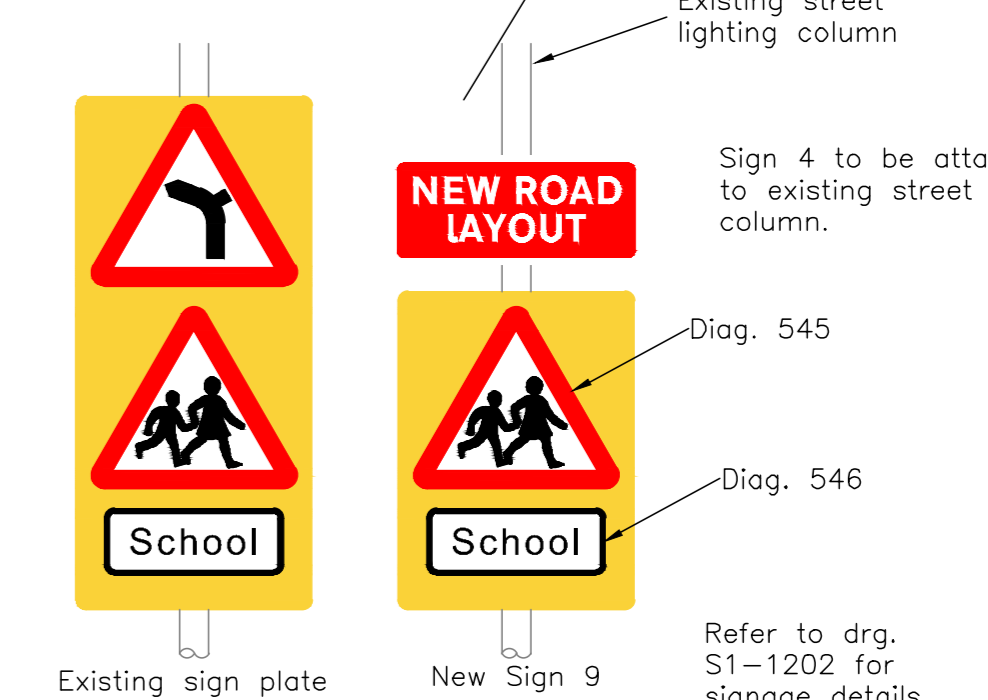
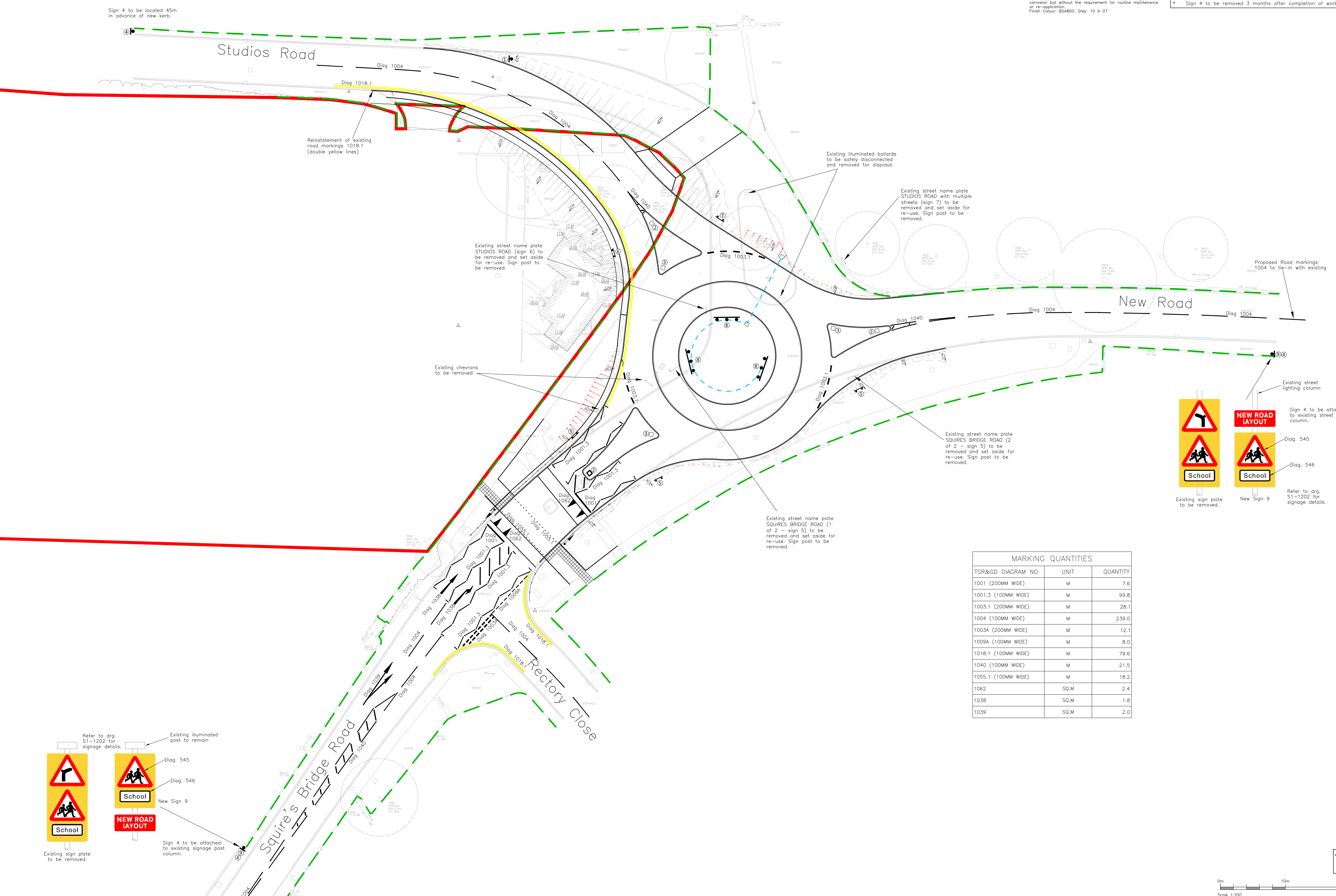

MARKING QUANTITIES		
TSR&GD DIAGRAM NO	UNIT	QUANTITY
1001 (200MM WIDE)	M	7.6
1001.3 (100MM WIDE)	M	99.8
1003.1 (200MM WIDE)	M	28.1
1004 (100MM WIDE)	M	239.0
1003A (200MM WIDE)	M	12.1
1009A (100MM WIDE)	M	8.0
1018.1 (100MM WIDE)	M	79.6
1040 (100MM WIDE)	M	21.5
1055.1 (100MM WIDE)	M	18.2
1062	SQ.M	2.4
1038	SQ.M	1.8
1039	SQ.M	2.0

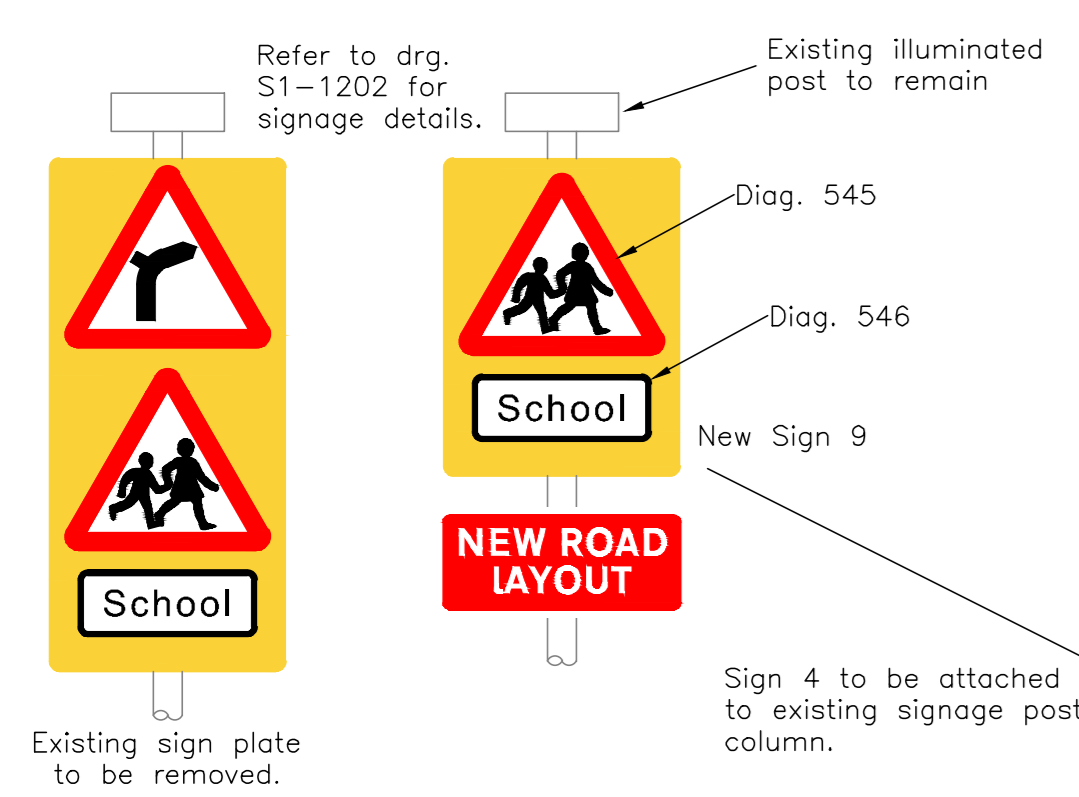

Rev	Date	Description	Drawn	Check
#	26/03/21	First Issue	PRAC	
P1	06/08/21	Amended per Technical Approval & PSA2 comments.	LK	RMH
A	30/11/21	Electric supply ducting route added.	DRM	CI

**FOR TECHNICAL APPROVAL**

Client  
**Pinewood Studios Group Ltd**

Project  
**Shepperton Highway Works - Phase 1**

Drawing Title  
**Section 278 - Series 1200  
J1 - Studios Road /  
New Road Roundabout  
Signs & Road Markings**

Drawing No. **P947-S1-1201** Rev. A  
Date: January 2021 Scale: 1:200 @ A0  
E-Mail: pchurchward@pfapl.com

