

0 10 100
Millimetres

DO NOT SCALE

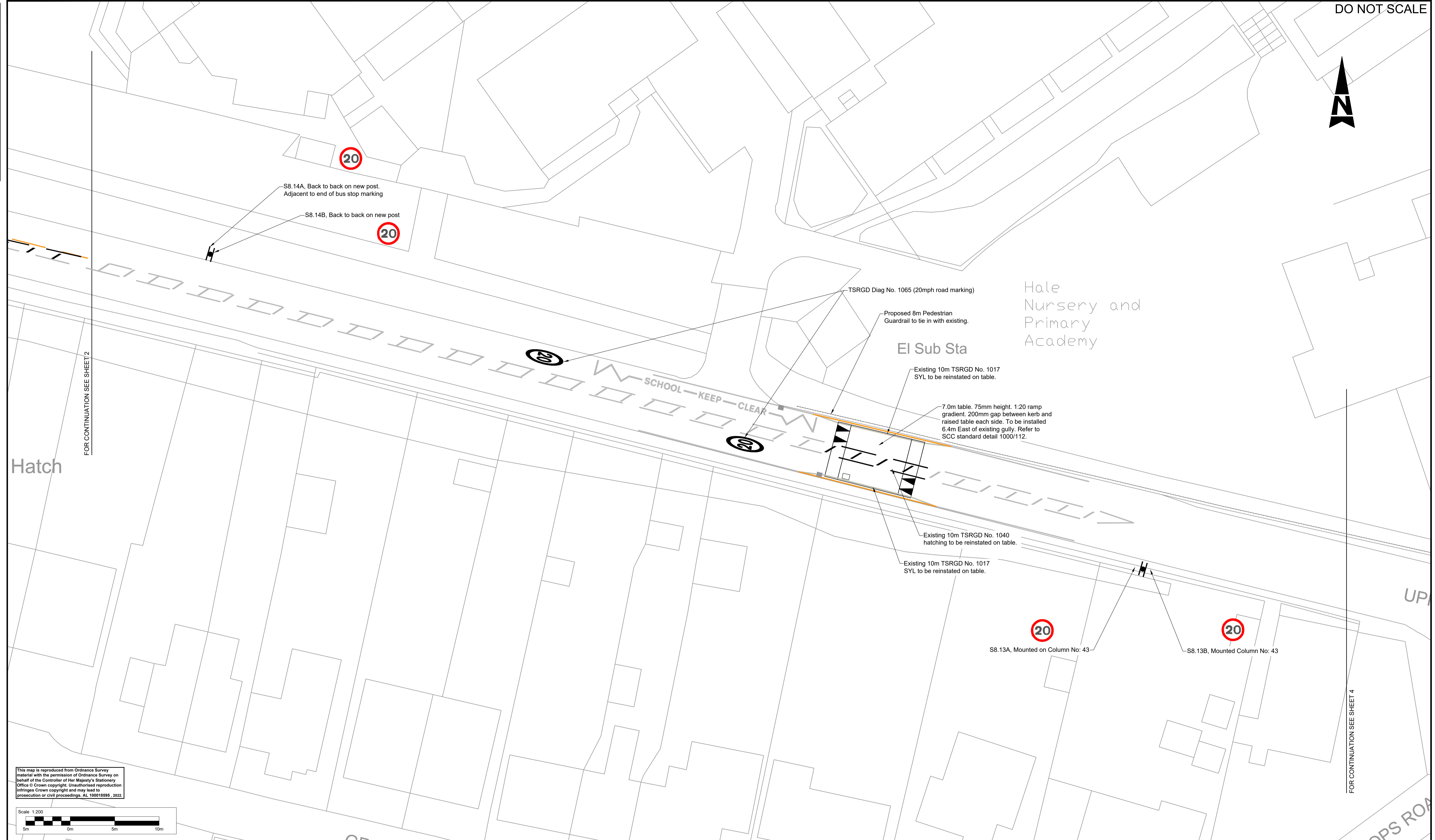

Hatch

FOR CONTINUATION SEE SHEET 2

FOR CONTINUATION SEE SHEET 4

This map is reproduced from Ordnance Survey material with the permission of Ordnance Survey on behalf of the Controller of Her Majesty's Stationery Office © Crown copyright. Unauthorised reproduction infringes Crown copyright and may lead to prosecution or civil proceedings. AL 100018595, 2022.



- NOTES:**
- IT IS THE CONTRACTORS RESPONSIBILITY TO CHECK THE LOCATIONS OF THE EXISTING STATUTORY SERVICES PRIOR TO CONSTRUCTION. PARTICULAR ATTENTION IS DRAWN TO THE 'NEW ROADS AND STREET WORKS ACT 1991'
 - DO NOT SCALE AS BASE MAP IS ORDNANCE SURVEY MAP
 - ALL DIMENSIONS IN METRES UNLESS SPECIFIED
 - EXCAVATED MATERIALS AND ITEMS IDENTIFIED TO BE DISPOSED OF TO BE REMOVED TO THE CONTRACTOR'S TIP OFF SITE
 - METHOD FOR REMOVING ROAD MARKINGS AGREED BY SCC HIGHWAY AUTHORITY TO BE HYDROBLASTING
 - DESIGN DRAWINGS OMIT ANY GULLIES/UTILITY COVERS WITHIN CONSTRUCTION AREA THAT DO NOT NEED TO BE ADJUSTED
 - ALL STREET FURNITURE INSTALLMENTS TO MAINTAIN A MINIMUM LATERAL CLEARANCE FROM THE CARRIAGEWAY OF 450MM
 - FOR SIGN SCHEDULE PLEASE REFER TO: SCCFH20-ATK-HSN-XX-SH-CH-0001
 - VISIBILITY OF ALL SIGNS TO BE MINIMUM DISTANCE OF 15m TO ONCOMING TRAFFIC. VEGETATION CLEARANCE SHOULD BE CARRIED OUT AS REQUIRED
 - ALL CHAINAGES SHOWN ARE INDICATIVE ONLY
 - FOR ROAD HUMPS SCHEDULE, REFER SCCFH20-ATK-HGN-XX-SH-CH-0001

SAFETY, HEALTH AND ENVIRONMENTAL INFORMATION						
In addition to the hazards/risks normally associated with the types of work detailed on this drawing, note the following:						
CONSTRUCTION						
NONE						
MAINTENANCE/CLEANING						
NONE						
DECOMMISSIONING/DEMOLITION						
NONE						
It is assumed that all works will be carried out by a competent contractor working, where appropriate, to an approved method statement						
Rev.	Date	Description	By	CHK'd	App'd	
P1	05/05/23	ORIGINAL ISSUE				

Drawing Status: **FOR REVIEW AND COMMENT**

ATKINS

Woodcote Grove
Ashley Road
Epsom
Surrey
KT18 5BW

Tel: +44 (0)1372 726140
Fax: +44 (0)1372 740055
www.atkinsglobal.com

Copyright © Atkins Limited (2014)

Client: **SURREY COUNTY COUNCIL**
Surrey Highways & Transport for Surrey

Project Title: FARNHAM SHORT-TERM INTERVENTIONS: 20mph SPEED LIMITS					
Drawing Title: UPPER HALE ROAD GENERAL ARRANGEMENT SHEET 3 OF 6					
Scale: 1:200	Designed: CM	Drawn: CM	Checked: PM	Authorised: TG	
Original Size: A1	Date: 05/05/23	Date: 05/05/23	Date: 09/05/23	Date: 09/05/23	Date: 09/05/23
Drawing Number: SCCFH20-XX	Originator: ATK-SK	Volume: -CH-	Project Ref. No.: 5206378	Revision: 0053	Number: P1
Location:	Type:	Role:	Number:		